

FORM NO. 1.

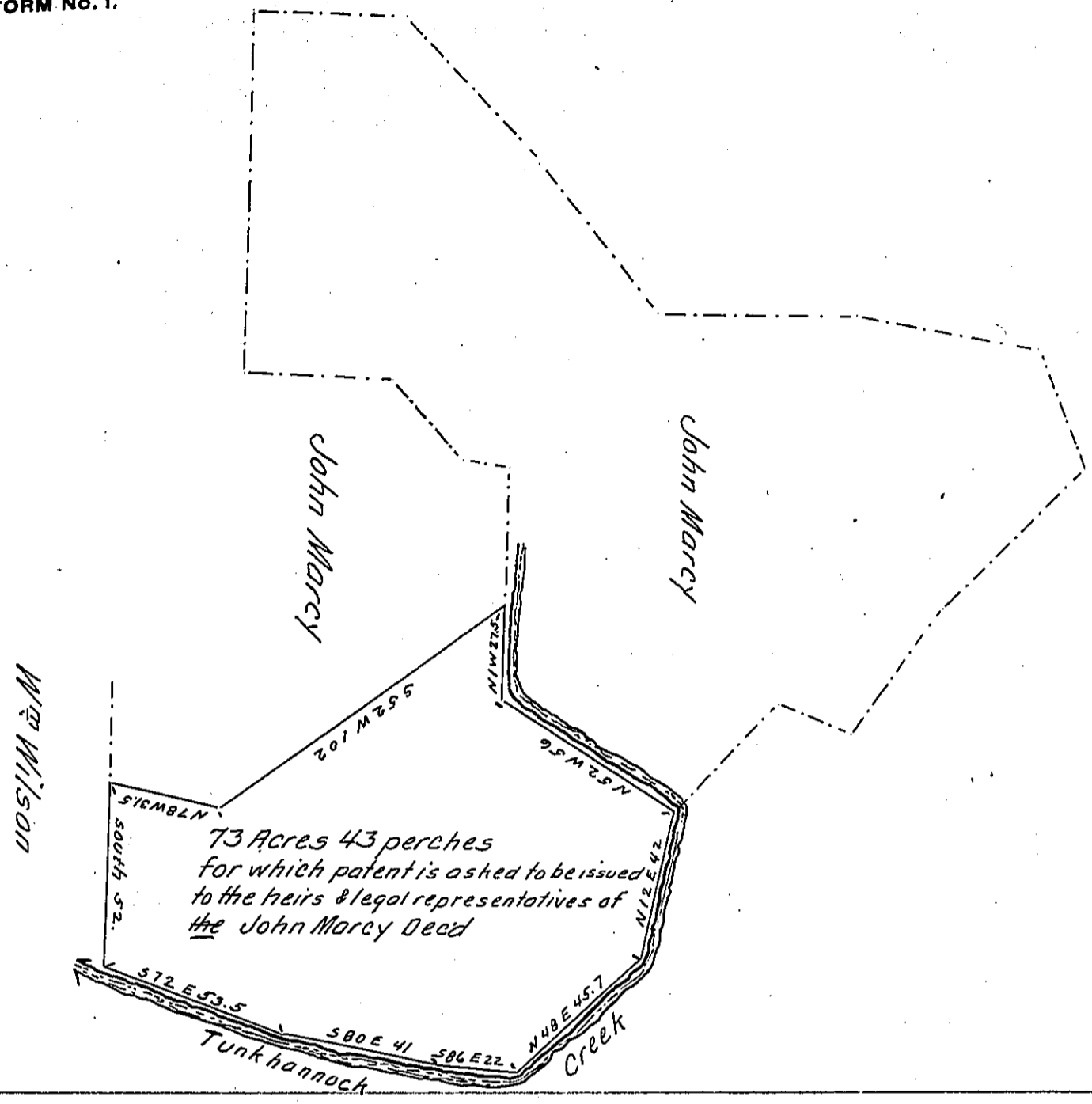

Made the above survey of 73 acres 43 perches and allowance of land March 23^d 1870. for the heirs and legal representatives of the estate of John Marcy Dec'd. said land being the southern part of a tract of land surveyed to the said John Marcy the 13th of July 1832. by virtue of his warrant dated the 9th of July 1832. the balance of the original tract is represented by the dotted lines.

To the Surveyor General. C. W. Hine C. S.

IN TESTIMONY that the above is a copy of the original remaining on file in the Department of Internal Affairs of Pennsylvania, made conformably to an Act of Assembly approved the 16th day of February, 1833, I have hereunto set my Hand and caused the Seal of said Department to be affixed at Harrisburg, this twentieth day of March 1906.

George P. Dawson
Secretary of Internal Affairs.